



www.FleetwoodRV.com

36F Options: 089, 096, 109, 113, 126, 194, 220, 304, 470, 471, 580, 671, 833

TOP FLOORPLAN FEATURES

- Sleeps up to 7
- Two Full Baths
- Bunk Beds that Convert into a Large Wardrobe Storage
- Surge Protection
- Tarkett® Flooring
- Electric Fireplace at Feature Wall
- 26,000# Chassis

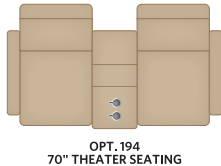
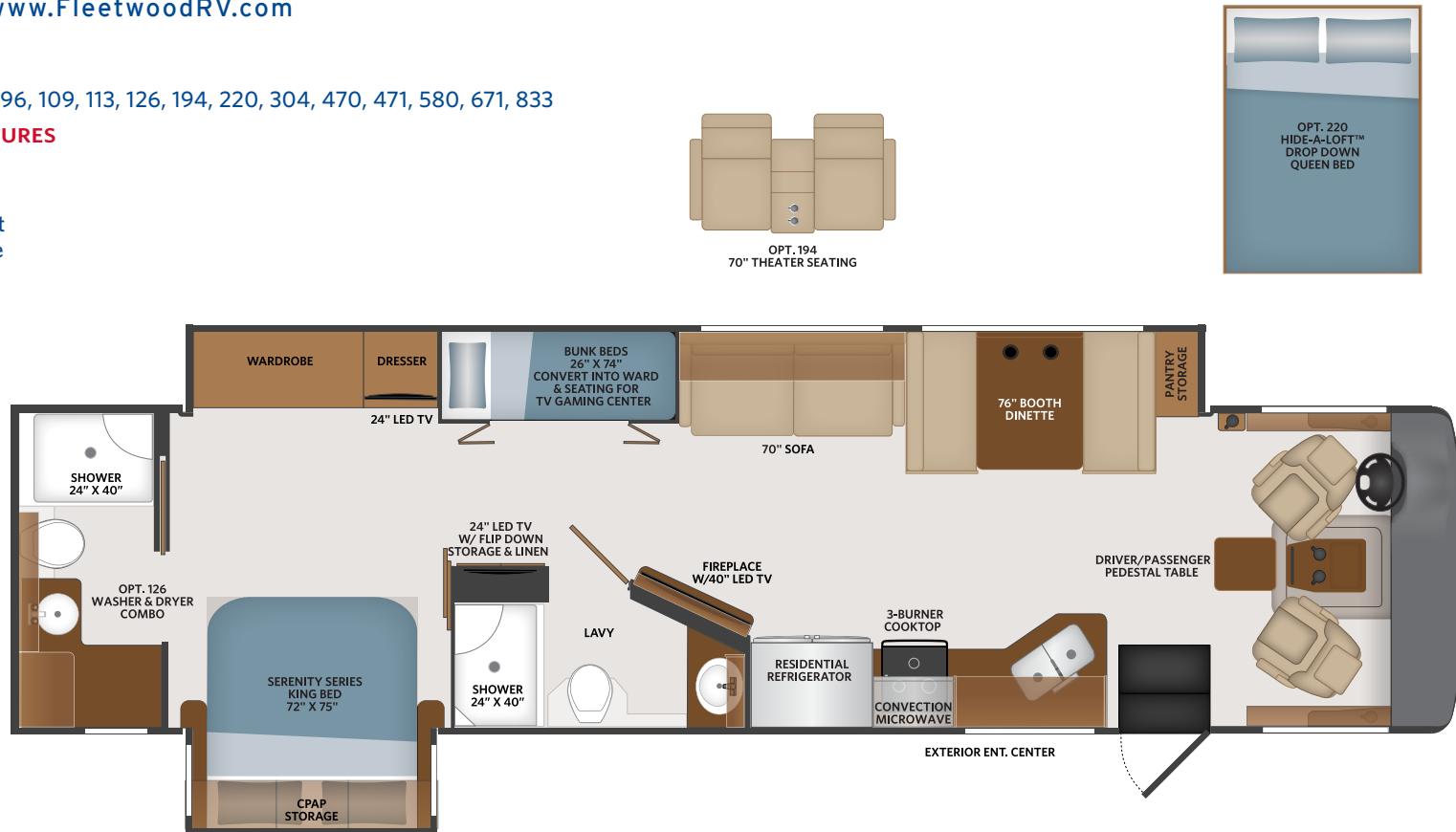

BOUNDER
OPTIONS

089	Upgraded WiFi Package	194	Theater Seating Sofa	580	Collision Mitigation
096	KING® Universal Satellite System	220	Hide-A-Loft™ Drop Down Queen Bed	671	Manual Power Cord Reel
109	Truma Tankless Water Heater	304	Solar Electrical Panel (265w)	833	Free Standing Dinette
113	Range -3 Burner Drop-in w/Oven	470	SumoSprings® - Front/Rear		
126	Washer/Dryer — All in one combo	471	Steering Stabilizer System		

FORD® CHASSIS

Model: Ford®
 Engine: 7.3L Triton V8
 Transmission: Ford® 6-Speed, Automatic w/Overdrive
 Alternator: 175 Amp
 Torque: 468 lb.-ft. @ 3,000 RPM
 Horsepower: 350HP @ 3,900 RPM



FLOORPLAN **36F**

20 | CLASS A GAS
22 | **BOUNDER**